

DWARKA PROJECT

AREA STATEMENT
TOTAL AREA OF THE SITE 8582.20 sq.mt.

S.NO.	FACILITY	PROPAREA IN SQ.MT. EACH PLOT	GRD. COV.	F.A.R.	MAX. HT.
1	PRIMARY SCHOOL	4180.84	33%	100	14m
2	NURSERY SCHOOL	808.14	33.33%	66.66	11m
3	C.S.C.	1150.0	40%	60	8m
4	RELIGIOUS	418.68	33.33%	66.66	8m
5	DISPENSARY	1000.0	33.33%	100	14m
6	E.S.S.	141.75			
7	COMM.ROOM	882.79	40%	100	11m

TOTAL 8582.20 SQ.M.

i) THE PLAN IS SUBJECT TO MODIFICATIONS WITHIN THE FRAMEWORK OF MASTER PLAN/ZONAL PLAN.
ii) IT IS FOR PLANNING PURPOSE & IS NOT FIT TO BE PRODUCED IN THE COURT OF LAW FOR PROPERTY DISPUTES.
iii) ALL THE DIMENSIONS & AREA GIVEN IN THE PLAN ARE SUBJECT TO CONFIRMATION OF OWNERSHIP/ALLOTMENT STATUS AND DEMARICATIONS/FEASIBILITY REPORT FROM THE DDA LANDS & ENGINEERING WING RESPECTIVELY.

NOTES: APPROVED BY COMMISSIONER (PLG.) ON PAGE 16N IN FILE NO FB(10)194/DWK/HAFB/PART I DT. 9/4/97
FEASIBILITY INCORPORATED AS PER FEASIBILITY REPORT OBTAINED FROM EX. ENGINEER/WD/10 VIDE LETTER NO. WD/10/3101/97/DDA/2681 DATED 21/5/97 IN FILE NO. F-2(30)197/DWK/HAF.

HOUSING AREA FACILITIES

LAY OUT PLAN PLOT No. 1

10 5 0 10 20 SCALE 1:500 Sector 23 PH-1

PLG. D/MAN PLG. ASST. DATE

ASST. DIRECTOR JT. DIRECTOR DIRECTOR

DELHI DEVELOPMENT AUTHORITY

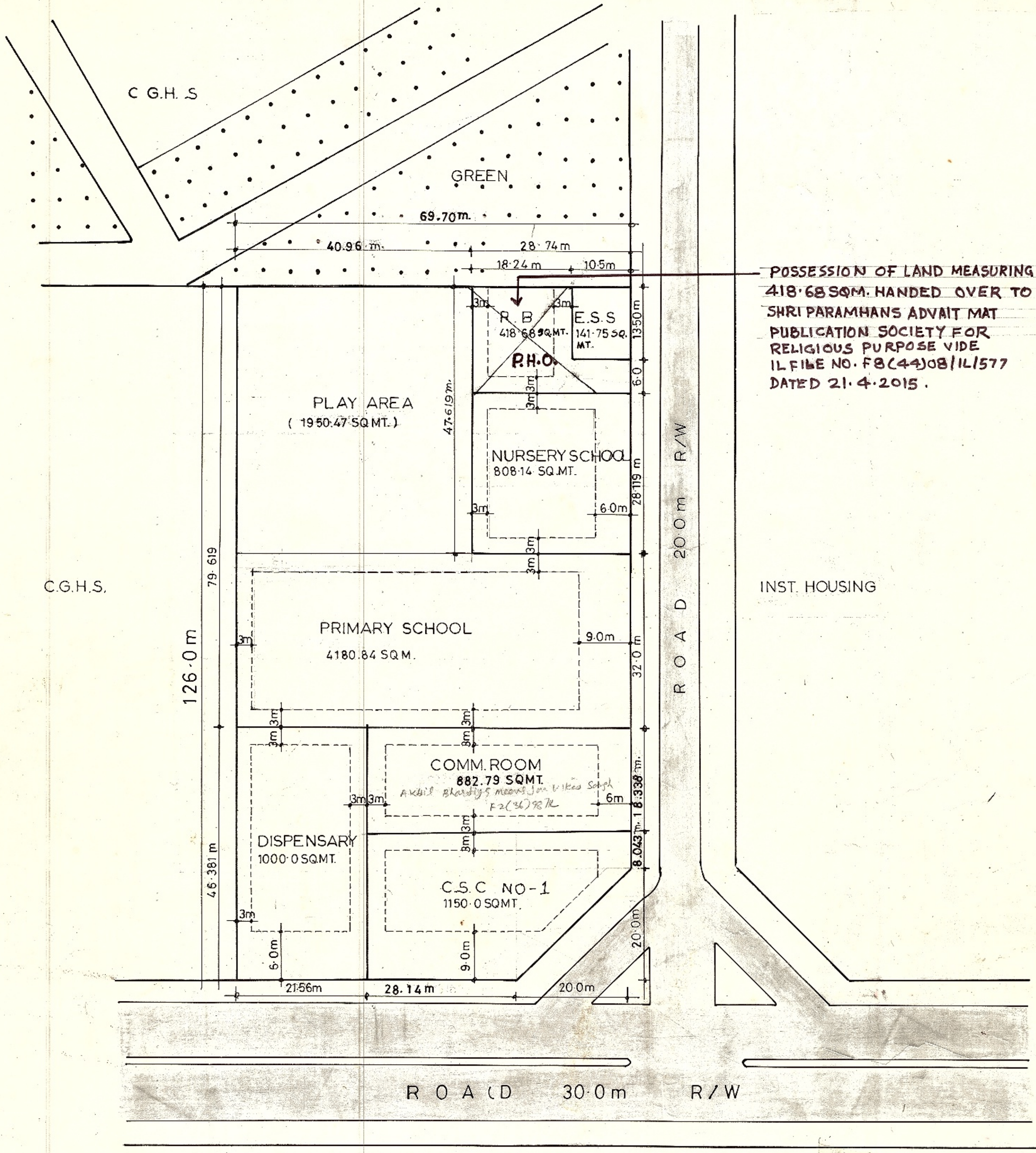

POSSESSION OF LAND MEASURING 418.68 SQ.M. HANDED OVER TO SHRI PARAMHANS ADVAIT MAT PUBLICATION SOCIETY FOR RELIGIOUS PURPOSE VIDE IL FILE NO. FB(44)08/11/577 DATED 21.4.2015.

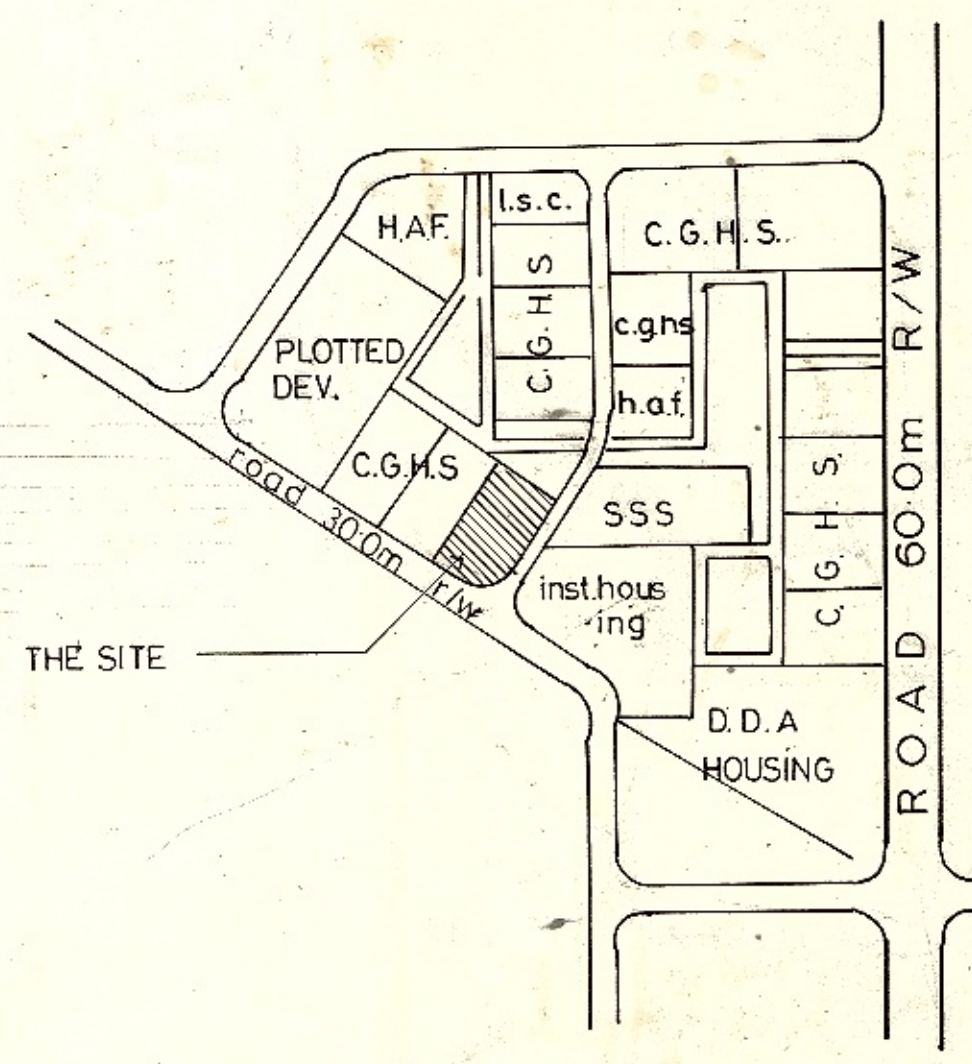

KEY PLAN
SCALE 1:8000